

PLANTA BAIXA 2º PAVIMENTO
ESCALA: 1/75

Armário 1 arquivo

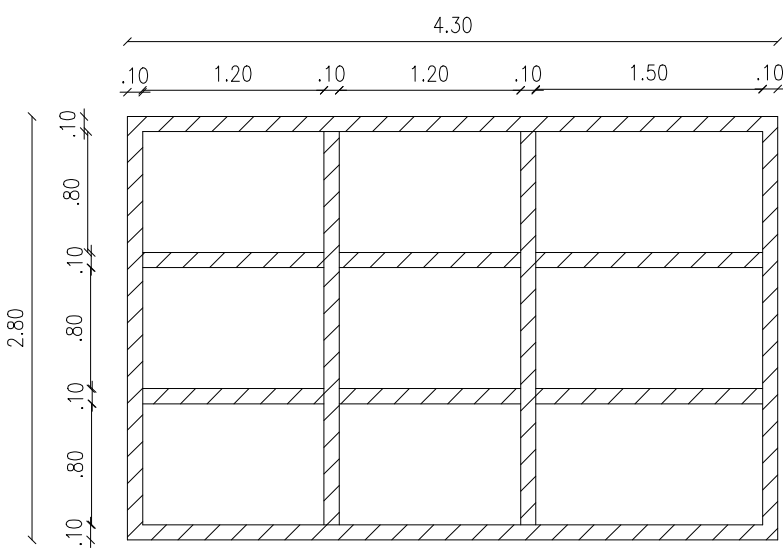

Armário cultura

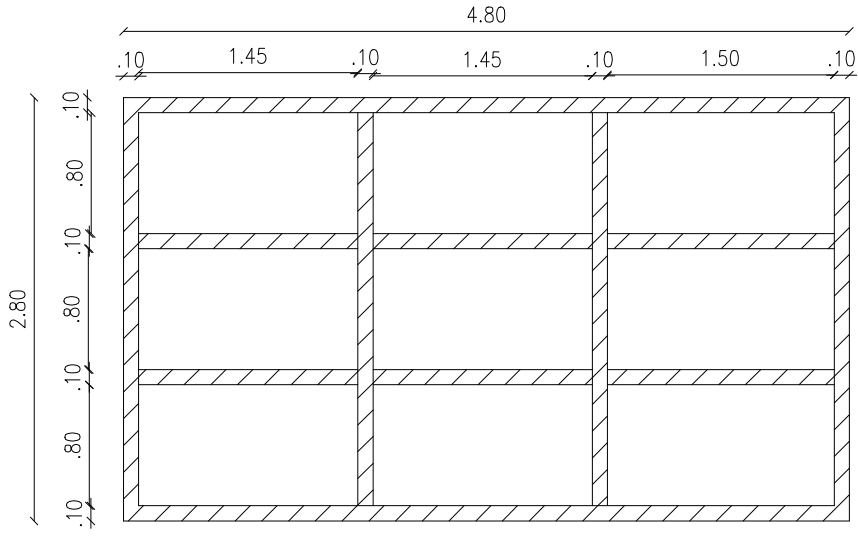

Armário compras

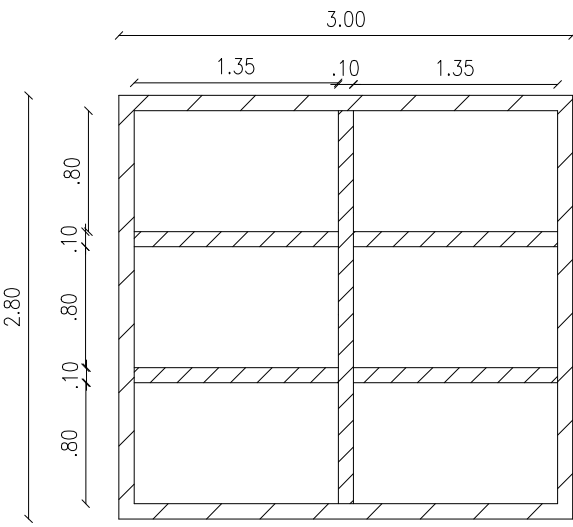

FACHADA
ESCALA: 1/100

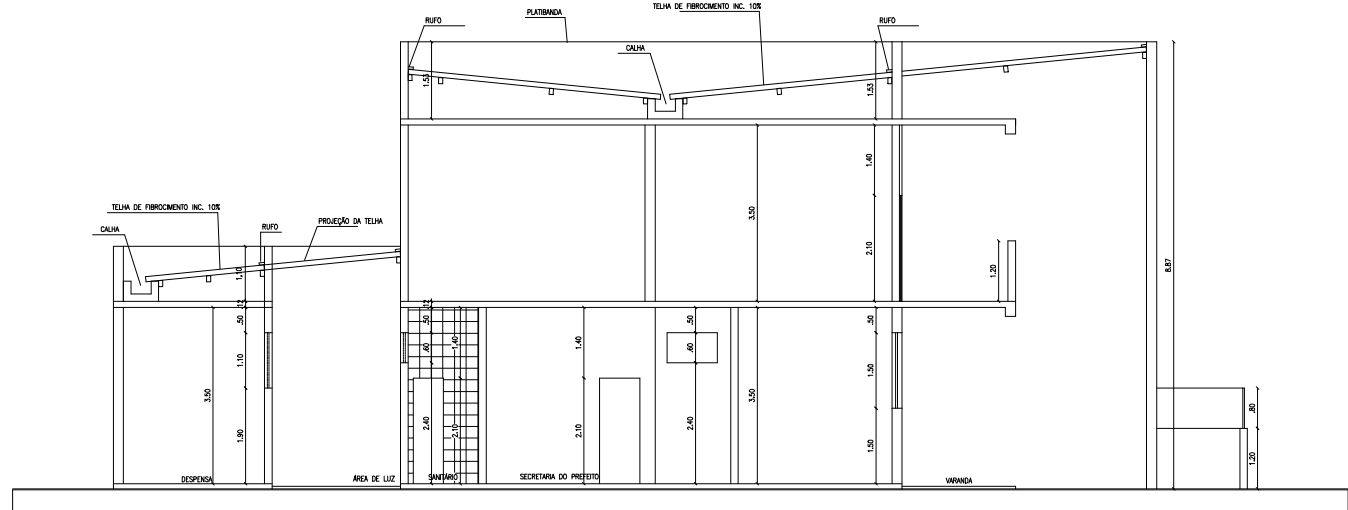

CORTE A-B
ESCALA: 1/100

Armário 2 Liquidação

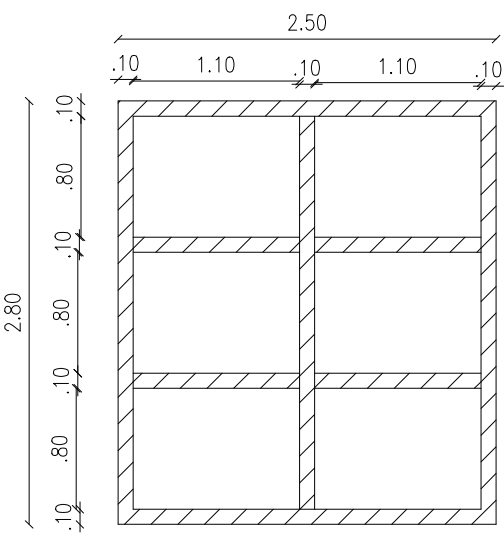

Armário 1 Liquidação

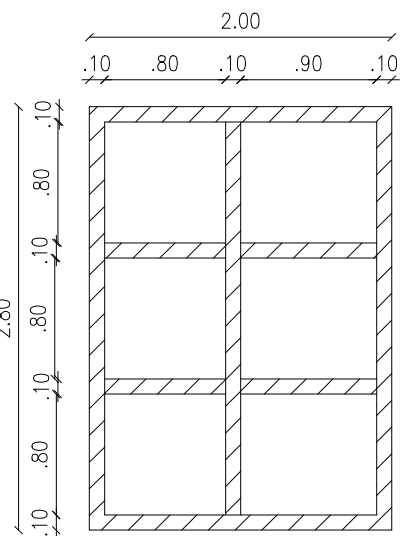

Armário Obras

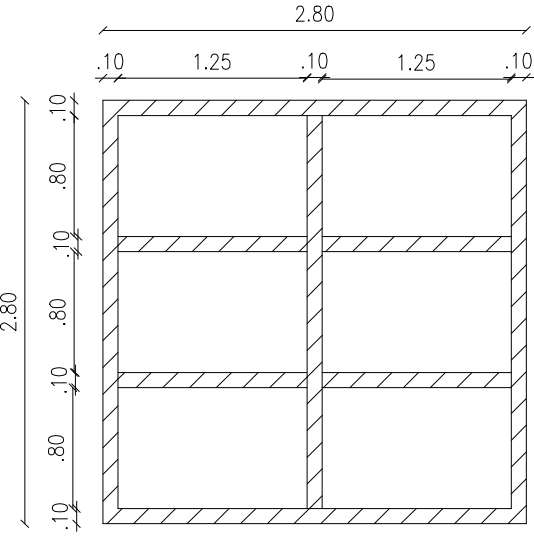

Armário Licitação

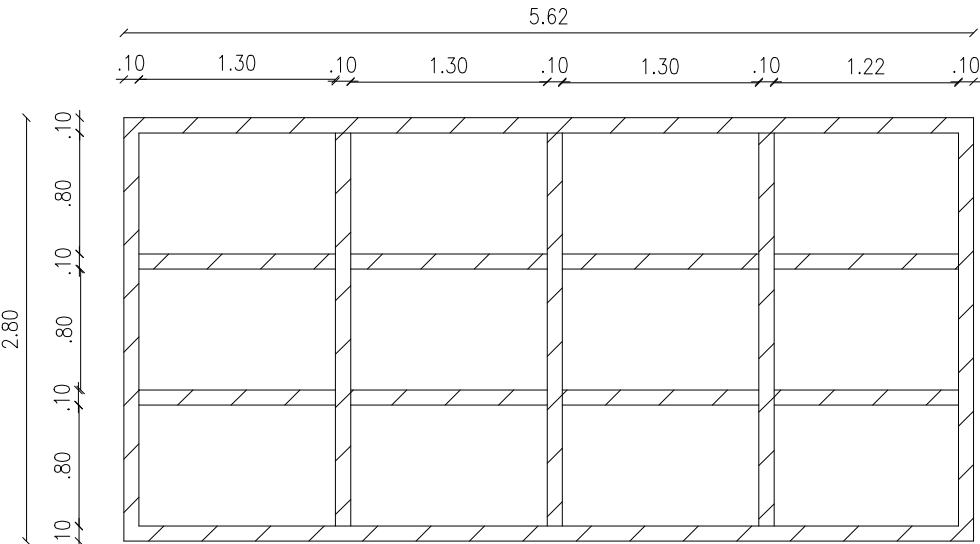

Armário 7 arquivo

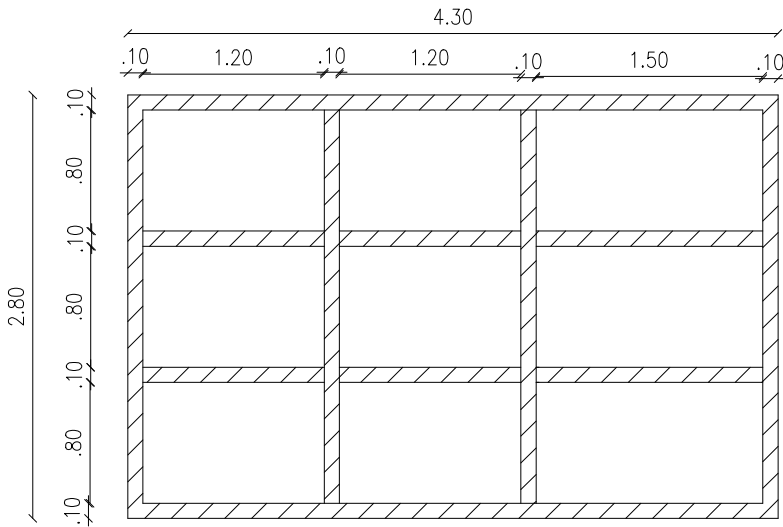

Armário 6 arquivo

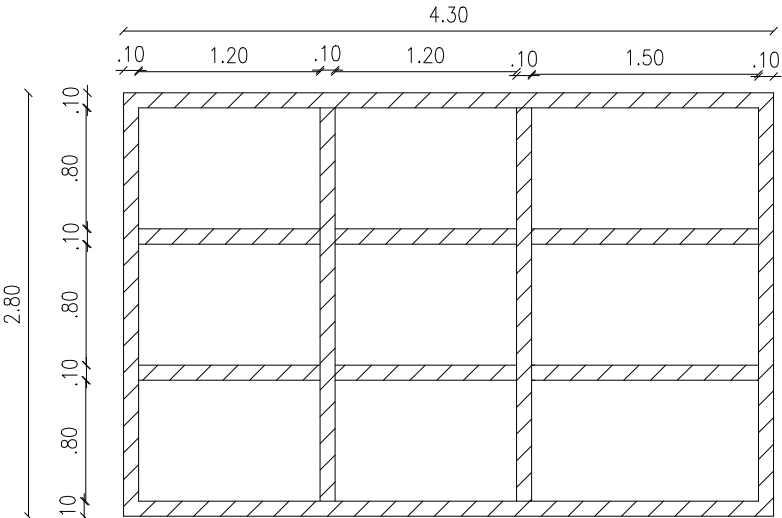

Armário 5 arquivo

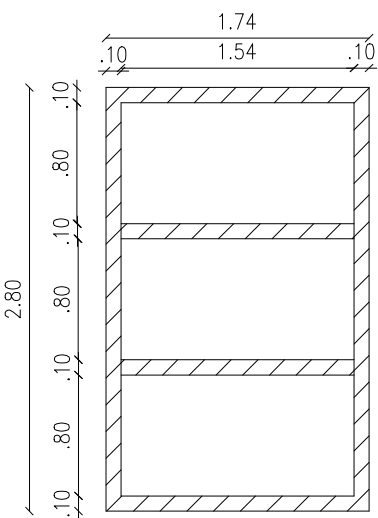

Armário 4 arquivo

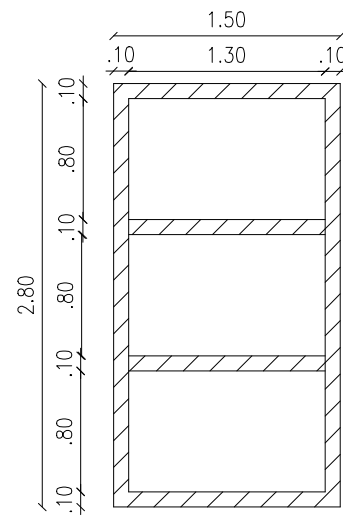

Armário 3 arquivo

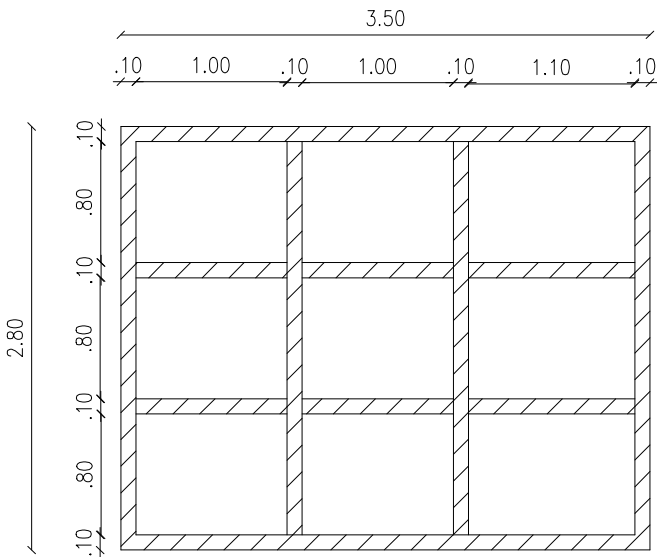

Armário 2 arquivo

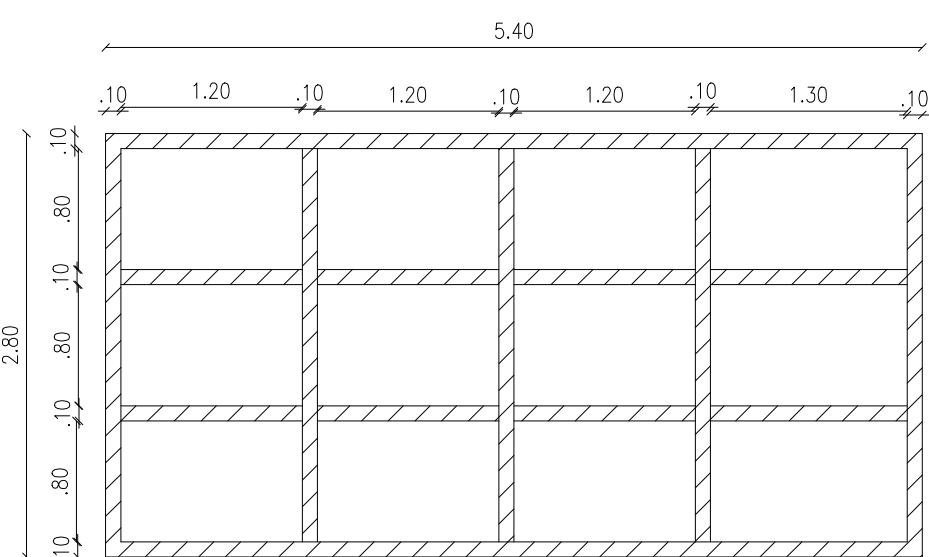

TÍTULO: REFORMA PREFEITURA MUNICIPAL DE DIVISA ALEGRE		ÁREAS: CONFORME QUADRO DE ÁREAS
USO: INSTITUCIONAL	DATA: MARÇO/2026	FOLHA: 01/02
DETALHES: INDICADOS	ESCALAS: INDICADAS	
LOGRADOURO: AVENIDA ALFREDO LUIZ BAHIA, 04		
BAIRRO: CENTRO		
CIDADE: Divisa Alegre - MG	CEP: 39995-000	
RESPONSÁVEL TÉCNICO:		
<div>PRISCILA SOUSA SANTOS</div> <div>ENGENHEIRA CIVIL - CREA-MG: 199436/D</div>		
PROPRIETÁRIO:		
<div>PREFEITURA MUNICIPAL DE DIVISA ALEGRE -MG</div> <div>CNPJ: 01.613.073/0001-11</div>		